

Seabourn Encore Seabourn Ovation

DECK PLANS

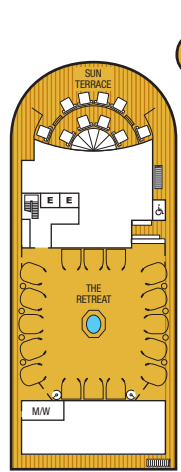

DECK 12

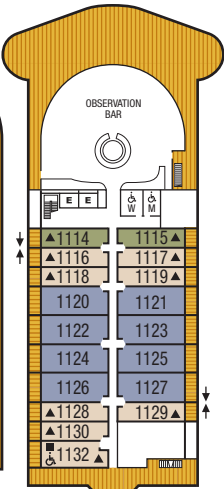

DECK 11

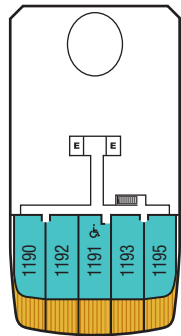

DECK 10

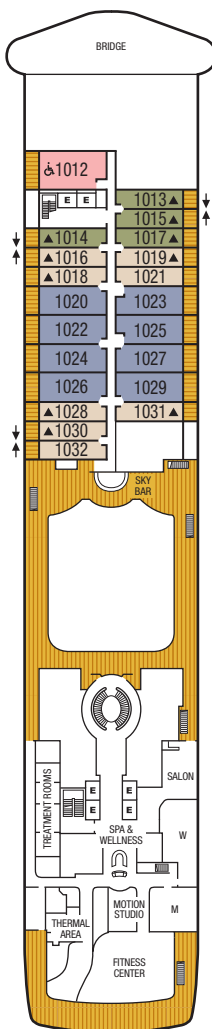

DECK 9

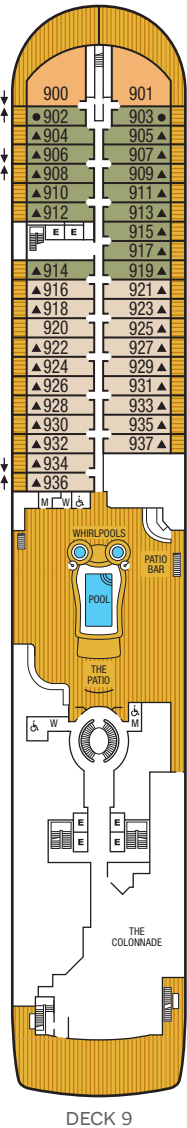

DECK 8

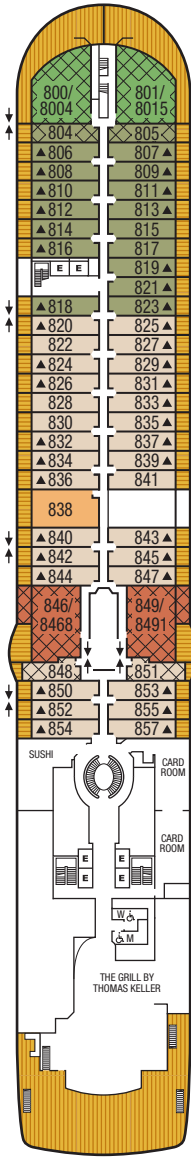

DECK 7

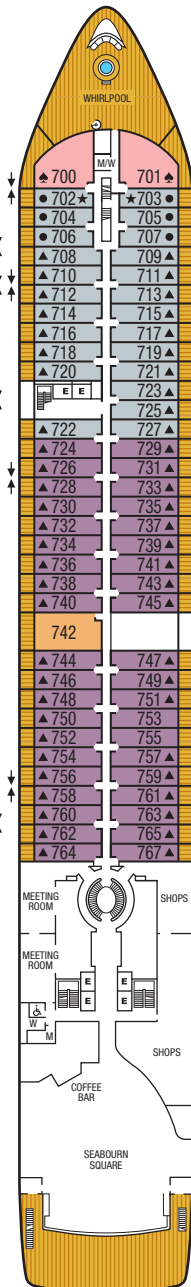

DECK 6

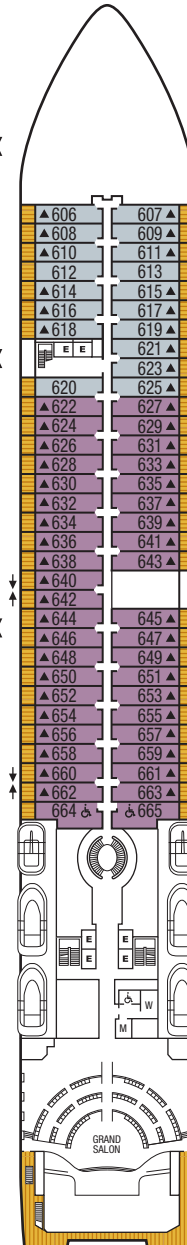

DECK 5

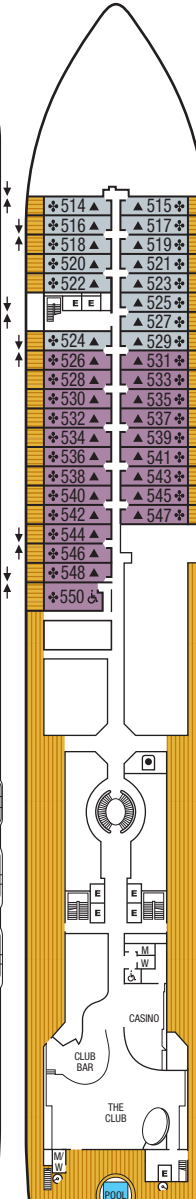

DECK 4

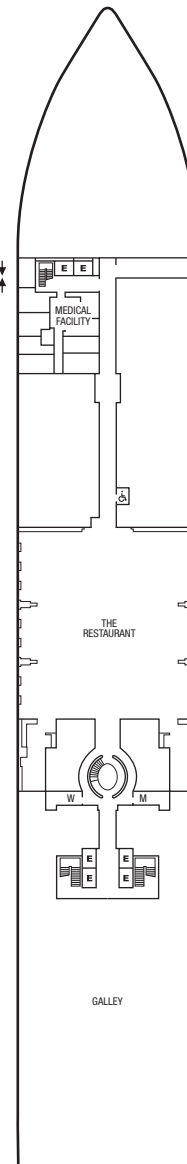

DECK 3

Connecting Suites

▲ When combining the following suites, their suite numbers change as follows:
 Suites 800 and 804 become Grand Signature Suite 8004;
 suites 801 and 805 become Grand Signature Suite 8015;
 suites 846 and 848 become Grand Wintergarden Suite 8468;
 suites 849 and 851 become Grand Wintergarden Suite 8491.

♿ **Wheelchair Accessible Suites**
 Suites 550, 664, 665, 1012, 1132, 1191 are wheelchair accessible—roll-in shower only, wheelchair-accessible doorways.

- ♣ Suites 700 and 701 are subject to noise when anchoring, and on Seabourn Encore, have all metal veranda railings, limiting the view. On Seabourn Ovation, the veranda railings are part metal and part glass from floor to teak rail.
- ★ The veranda railings on these suites are part metal and part glass. The forward half of the railing is metal and aft half is glass with teak rail.
- Obstructed port side view with larger veranda overlooking the center pool on Seabourn Encore only

- E Elevator
- ☒ Self Service Launderette
- ▲ Third Guest Capacity Suite—sofa converts to the size of a twin bed to accommodate one guest
- Shower Only
- ♣ The veranda railings on Deck 5 are part metal and part glass from floor to teak rail. Suites on Deck 5 have slightly larger verandas.

Deck plan shown is for illustration purposes. Seabourn reserves the right to make amendments and changes. Effective 11/15/20.

SUITE CATEGORIES

GR	WG	SS	O2	O1
PS	PH	V4	V3	V2
		V4	V3	V1

